

San Francisco State University  
J. Paul Leonard Library, Room 282  
Wednesday, May 14, 2014

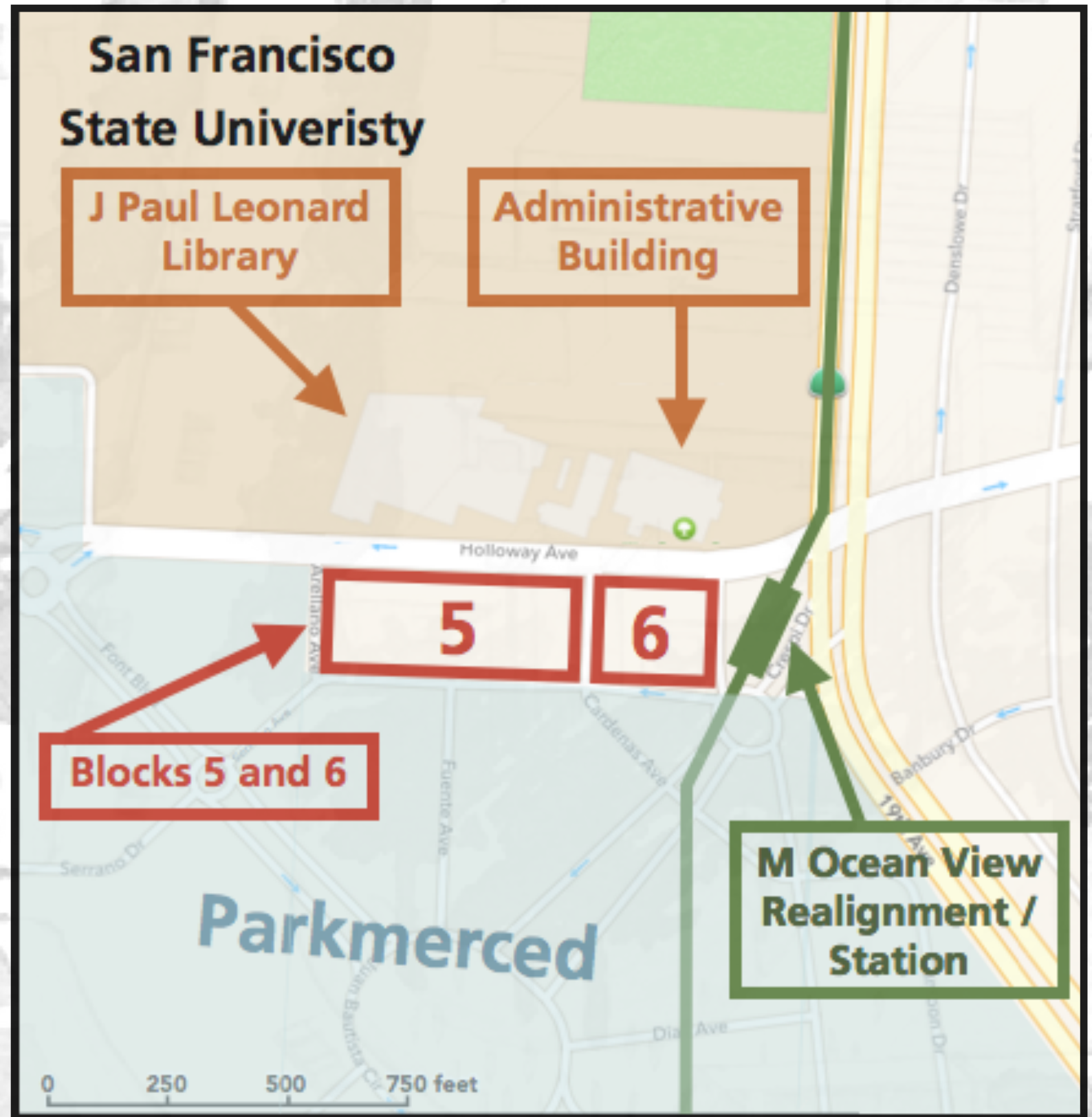

# Holloway Avenue Vision

- Parkmerced Redevelopment
- M Ocean View Realignment
- University Long-Term Growth





# Holloway Avenue Vision, Goals

- Redesign the main entrance of the university
- Reimagine Holloway Avenue as a key commercial corridor for the city's southwest neighborhoods
- Increase affordable student housing options on campus

An aerial sketch of an urban area, showing a grid of streets, various buildings of different heights, and clusters of trees. The style is a light, hand-drawn architectural rendering. The text is overlaid on the top half of the image.

# Holloway Avenue Vision, Alternatives

Holloway Avenue **Partial** Closure

---

Holloway Avenue **Complete** Closure





# Partial Closure Alternative

Kimberly Alas | Justin Balenzuela | DongKi Lee | Natalie Lewis | Haley Meisenholder



# Site + Circulation

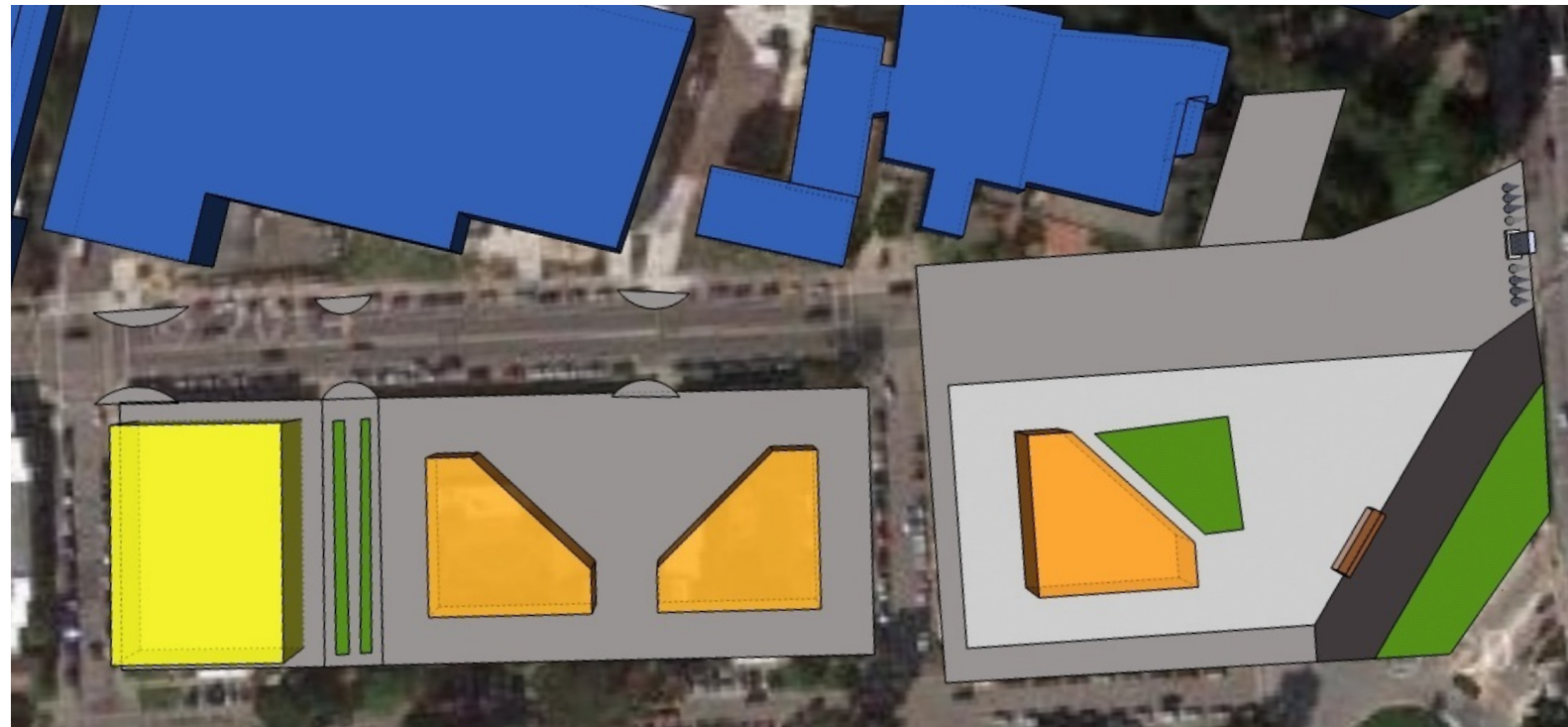
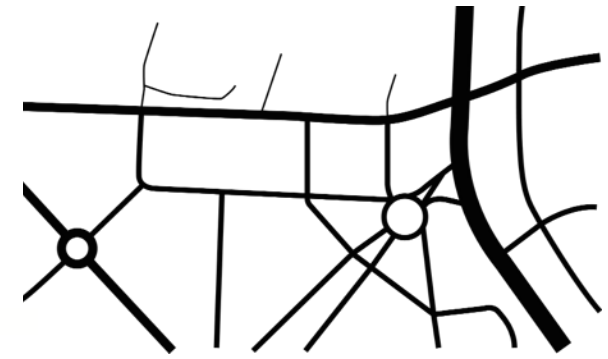

— Pedestrian

— Car

— Bike

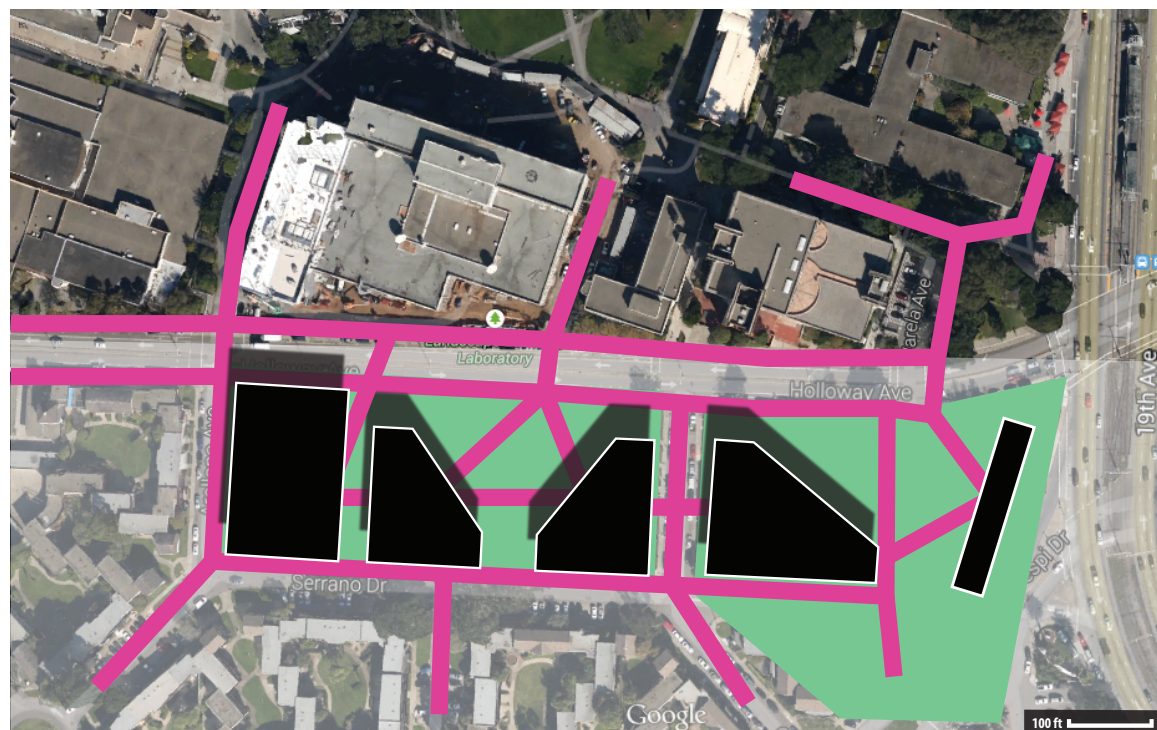



# Entrance

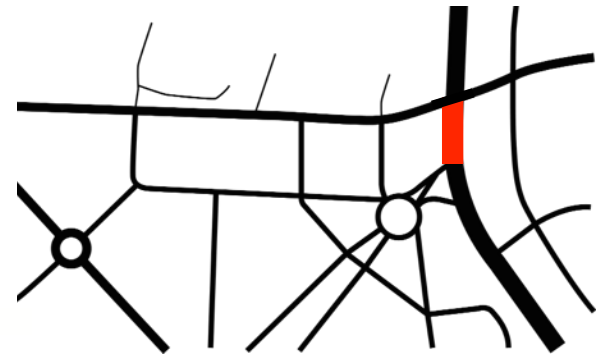

Base



Windstalk



# Housing

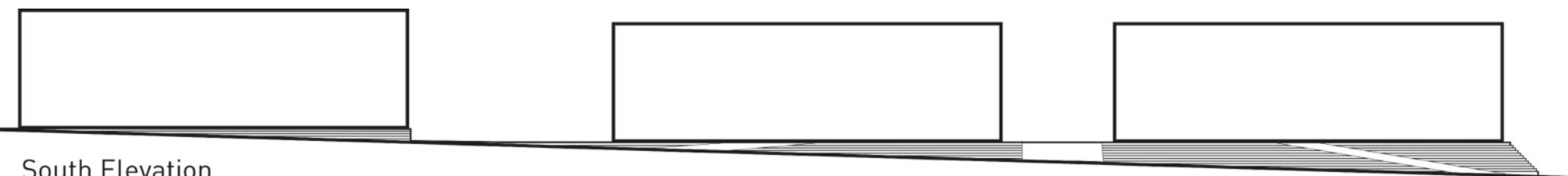
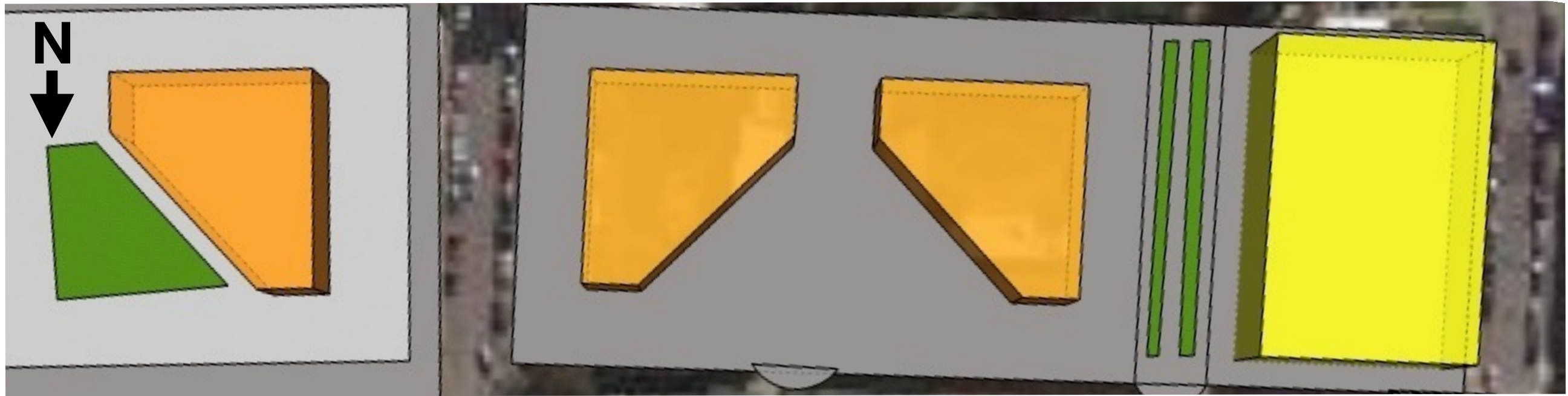
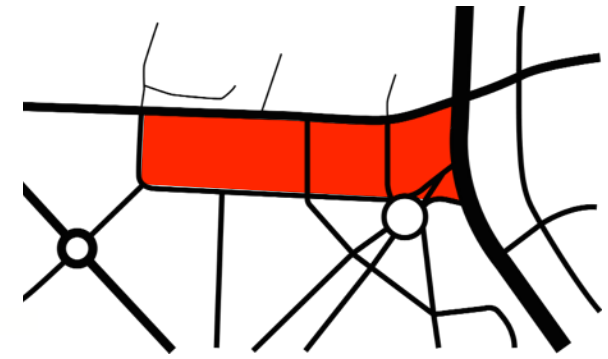

South Elevation



# Retail + Plaza

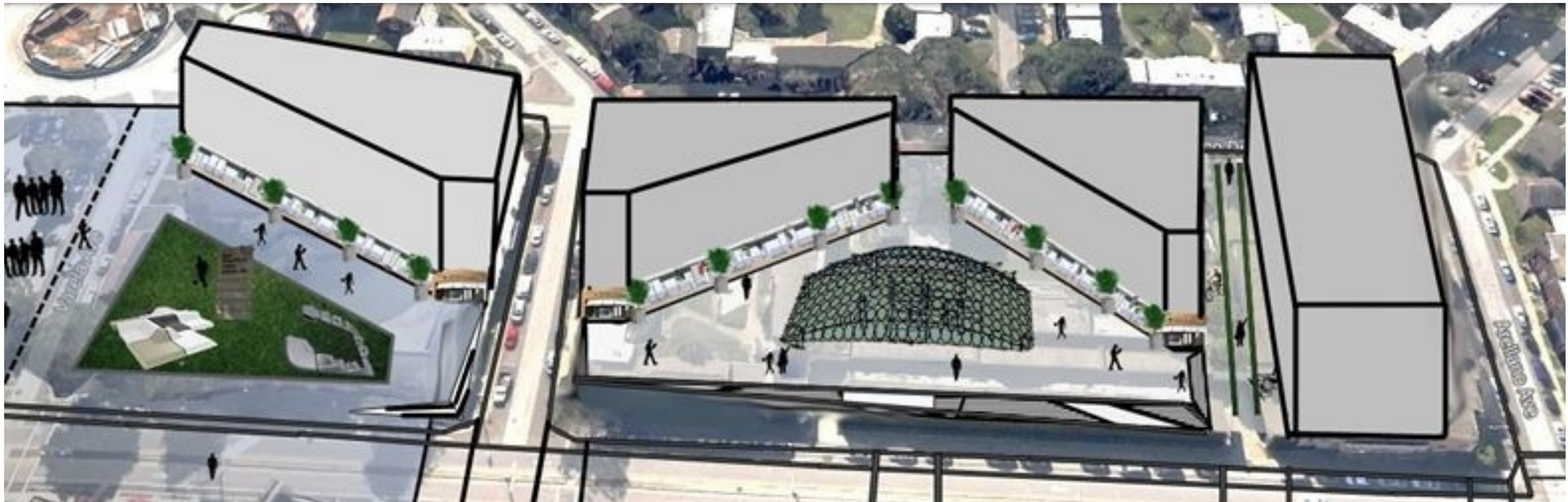
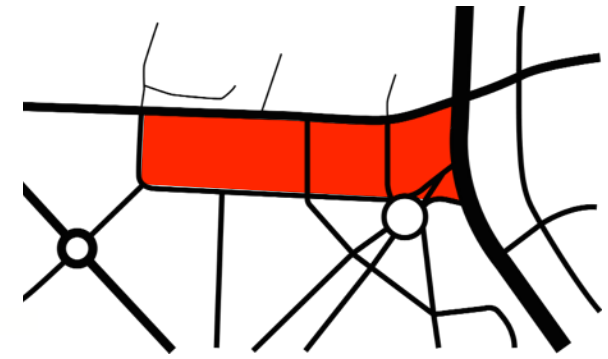



# Holloway Avenue

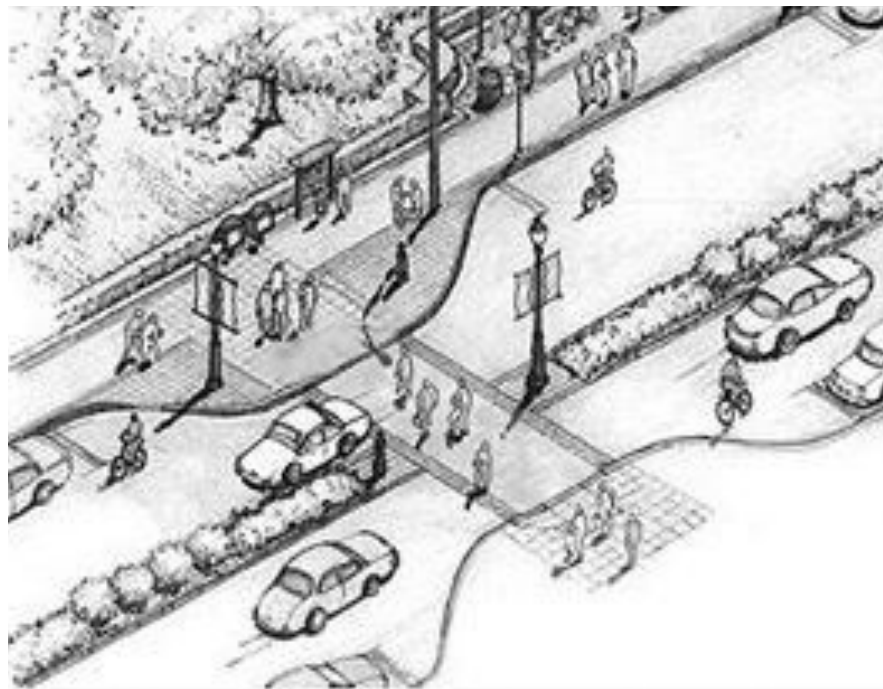
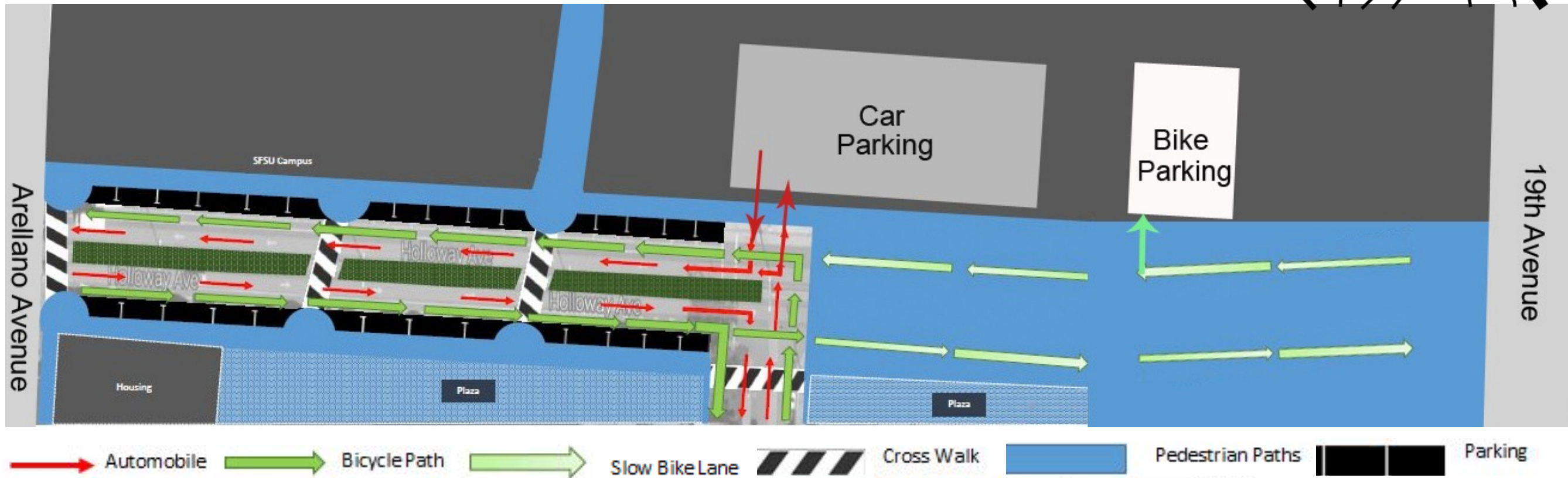
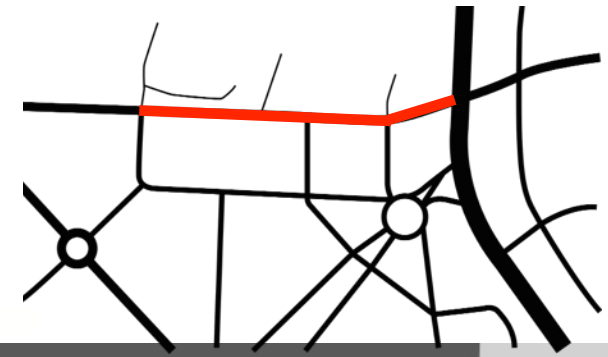



# Bike Station

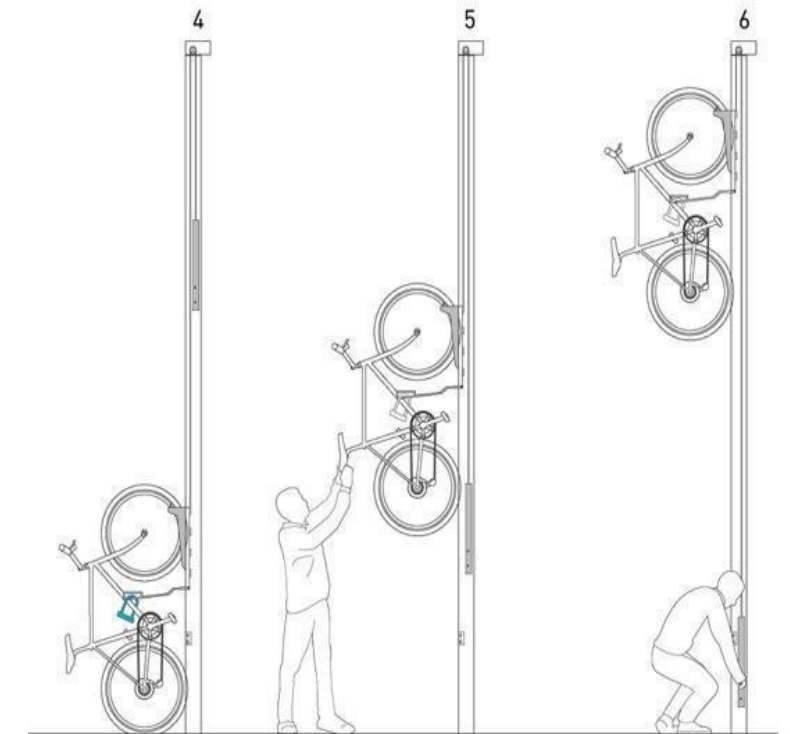
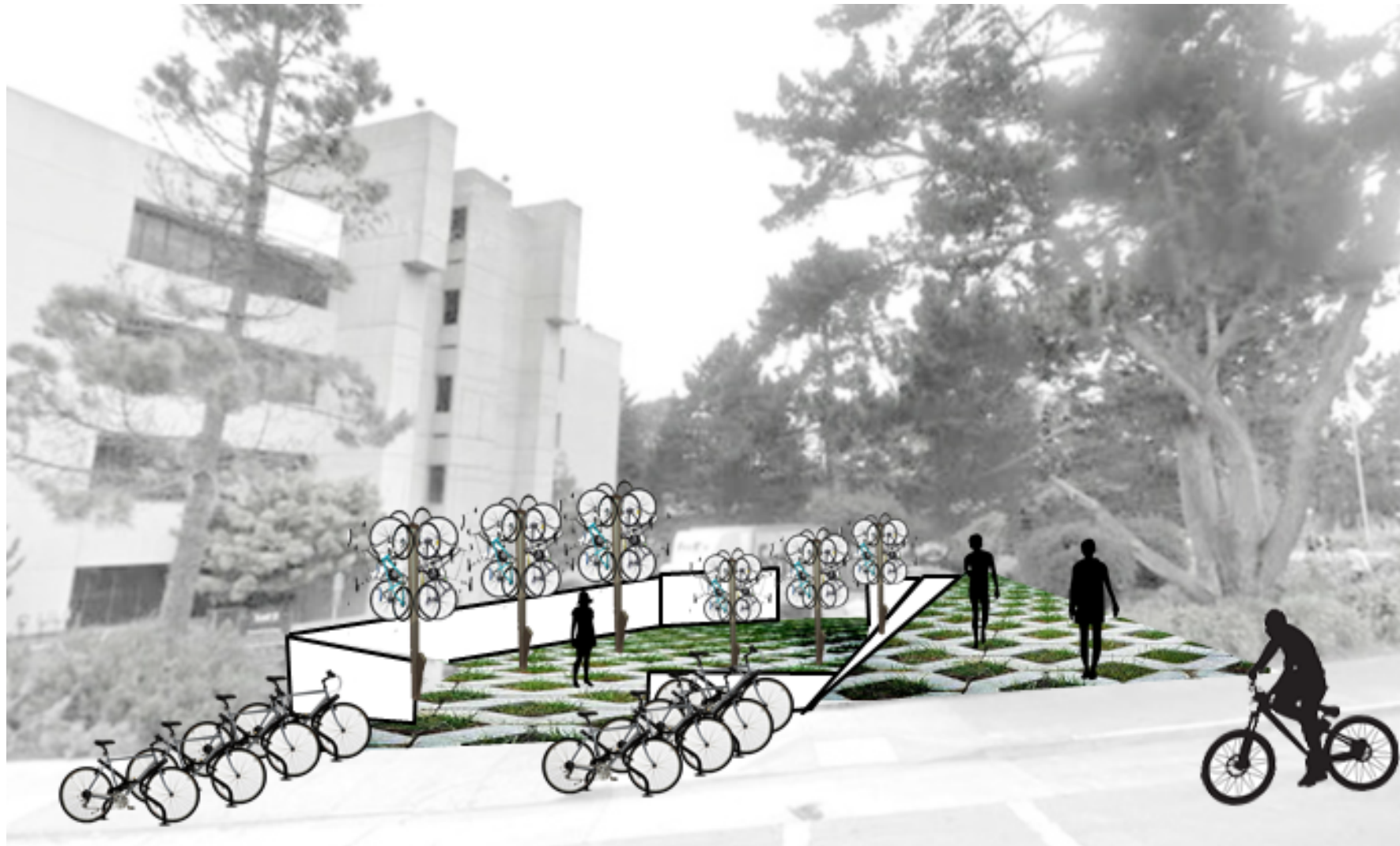
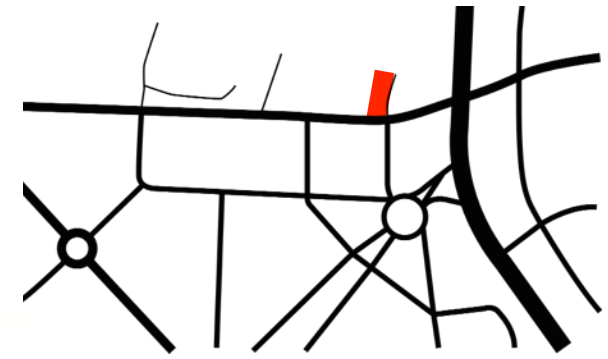



# Transit Terminal

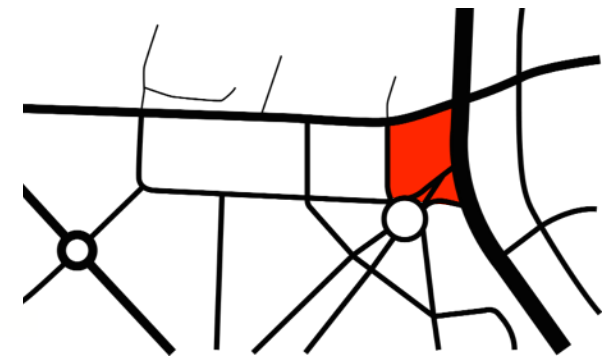

- 28 19th Avenue
- 29 Sunset
- 17 Parkmerced
- SF State Shuttles
- Stairs
- Elevator

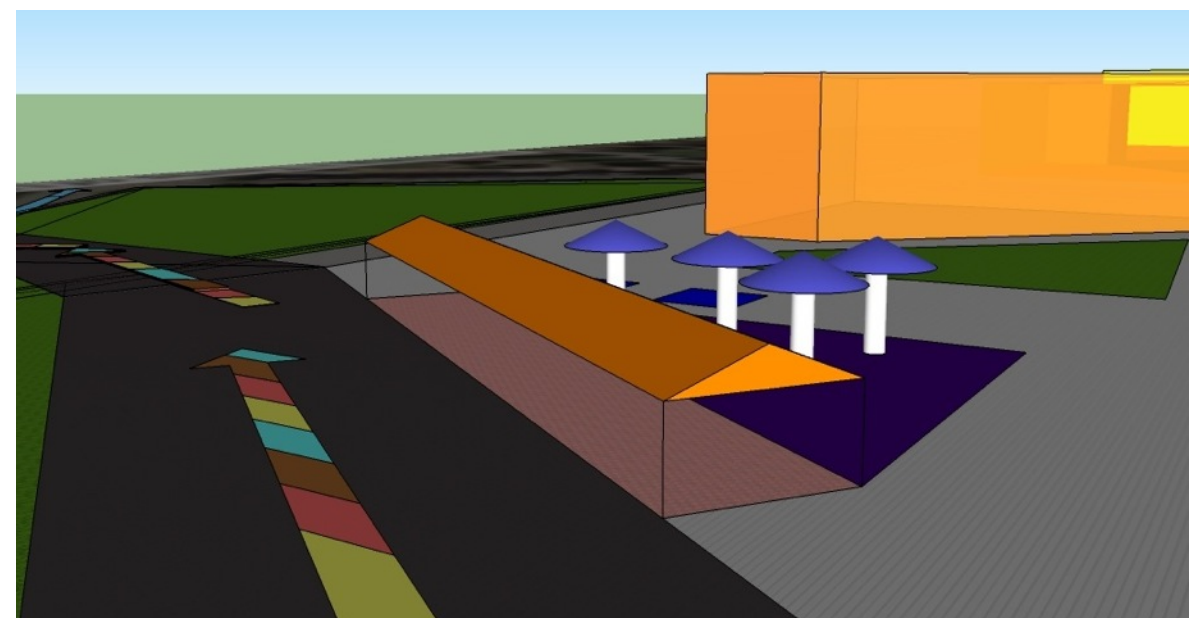
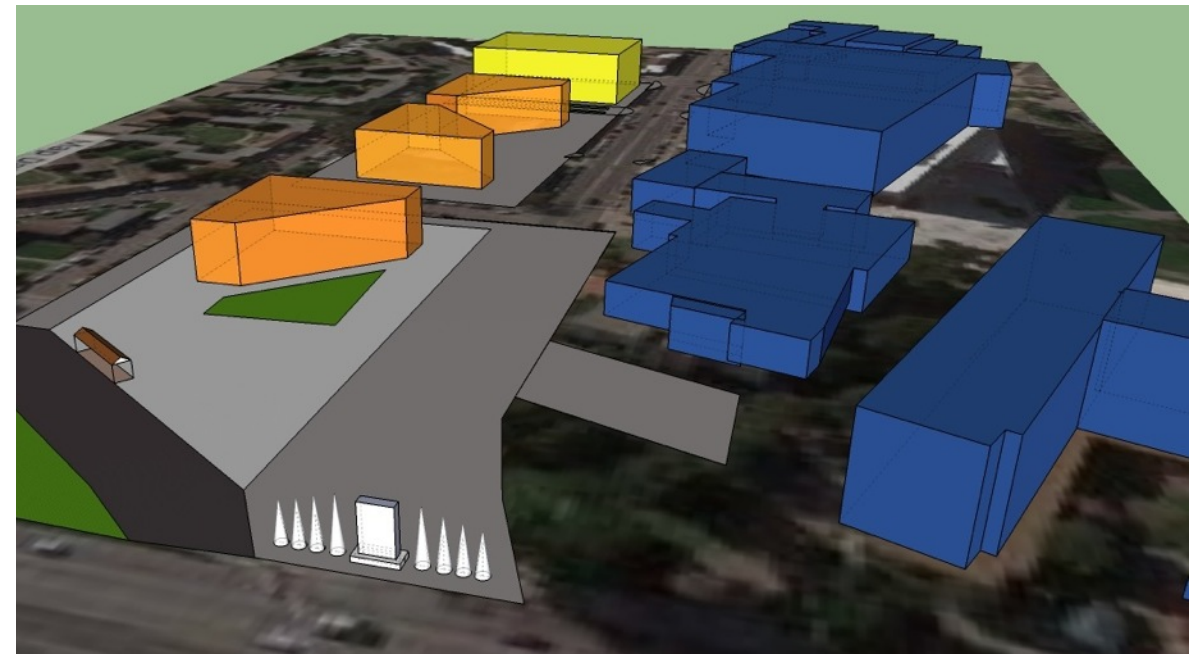
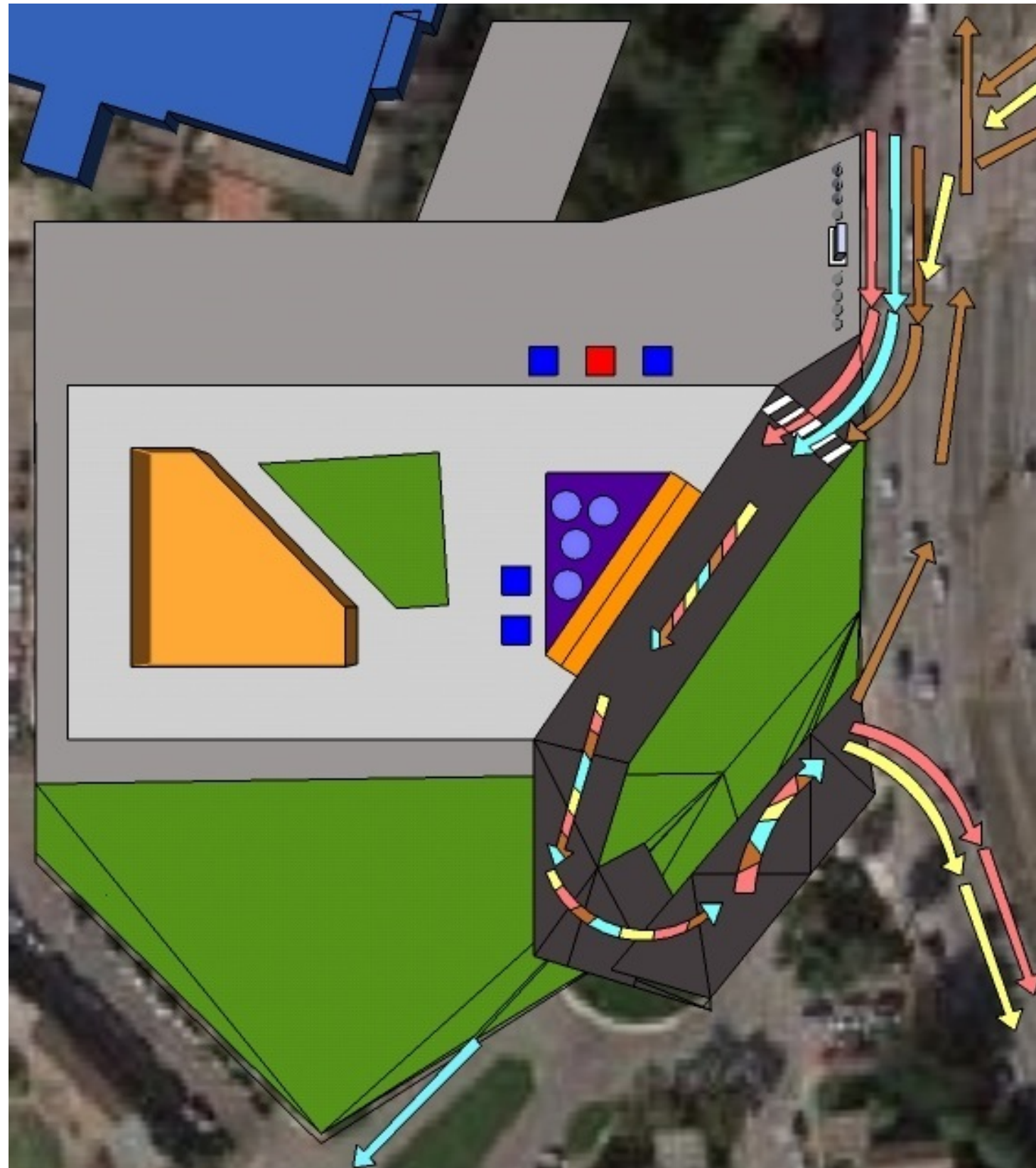



# SF State Station

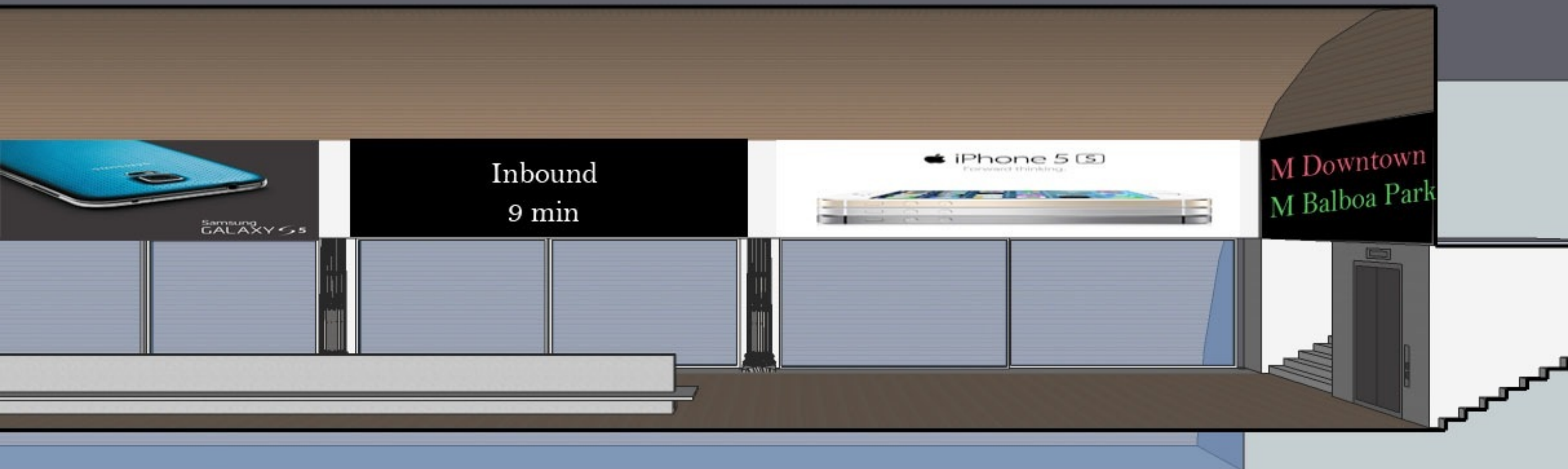
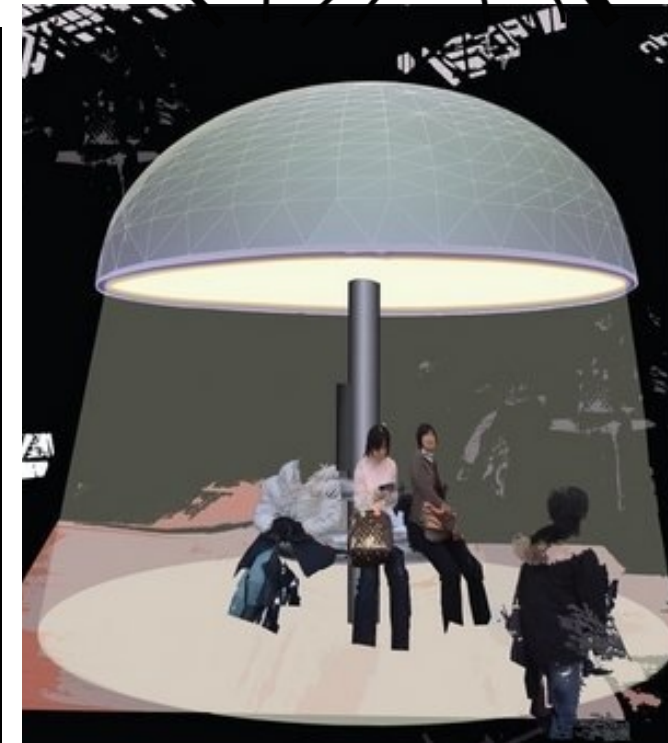
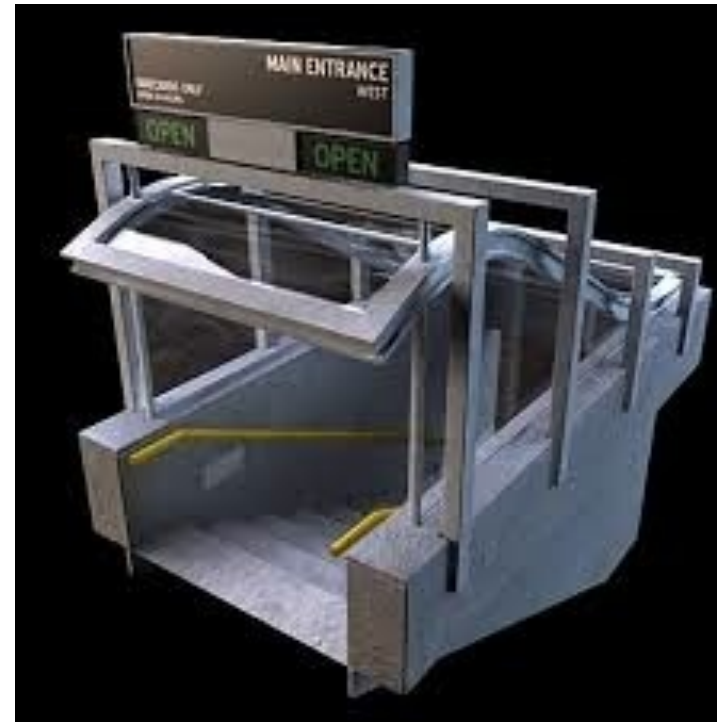
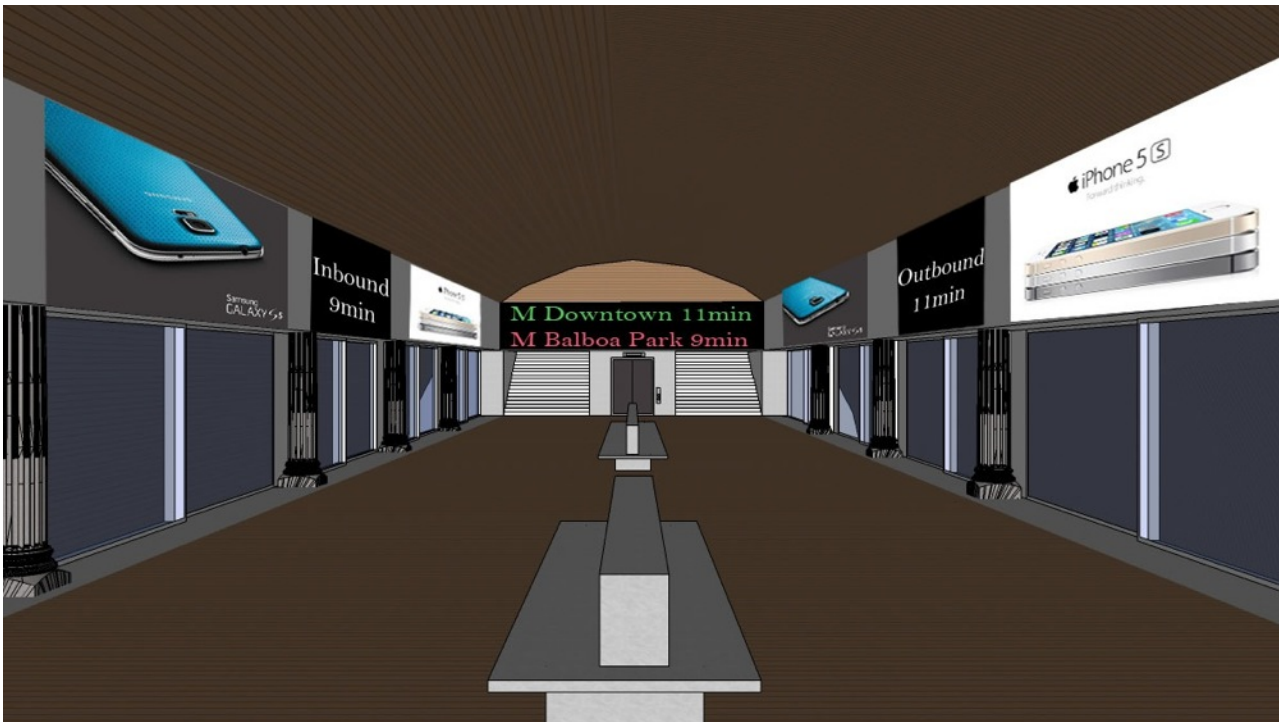
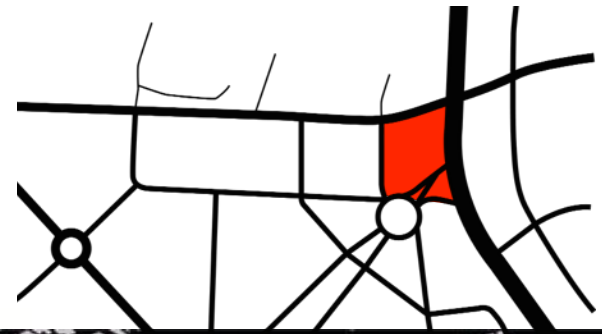



# Thank You





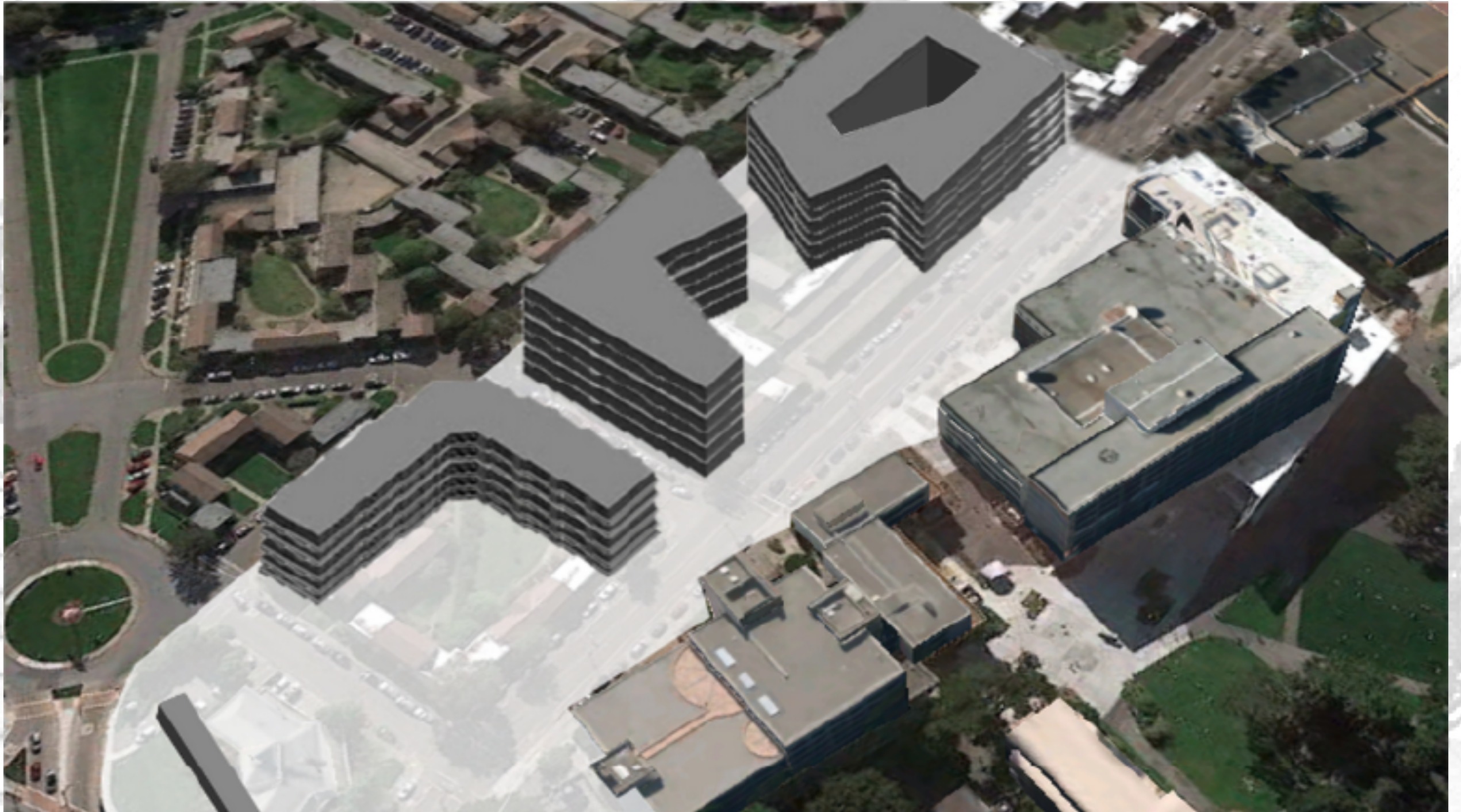

# Complete Closure Alternative

Jaime Cardenas | Zach Fahrney | Irene Ho | Brandon Northart | Marcia Yuriar



# Circulation

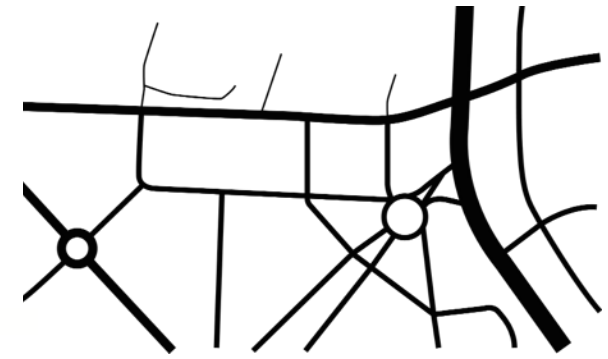

 Pedestrian

 Car

 Bike

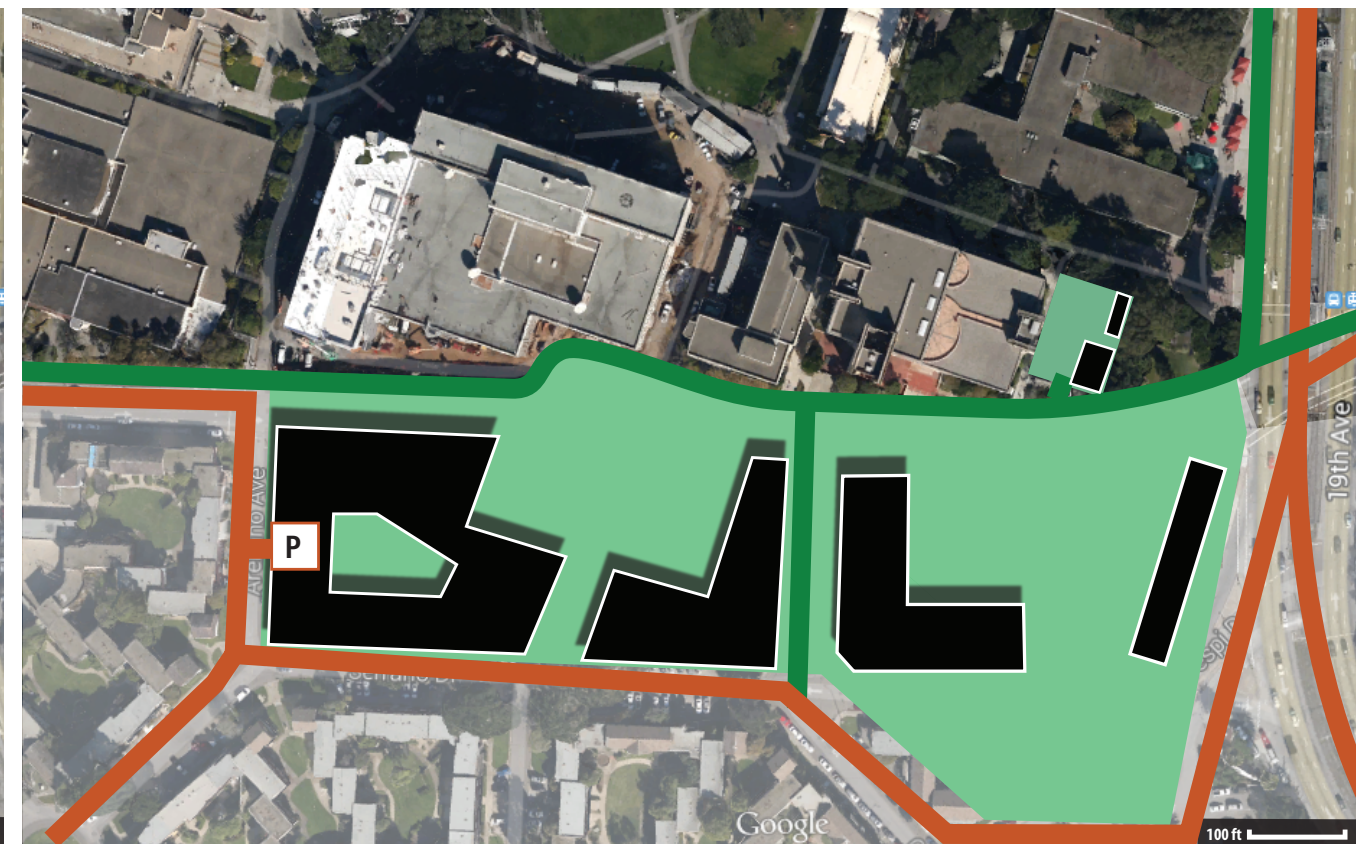
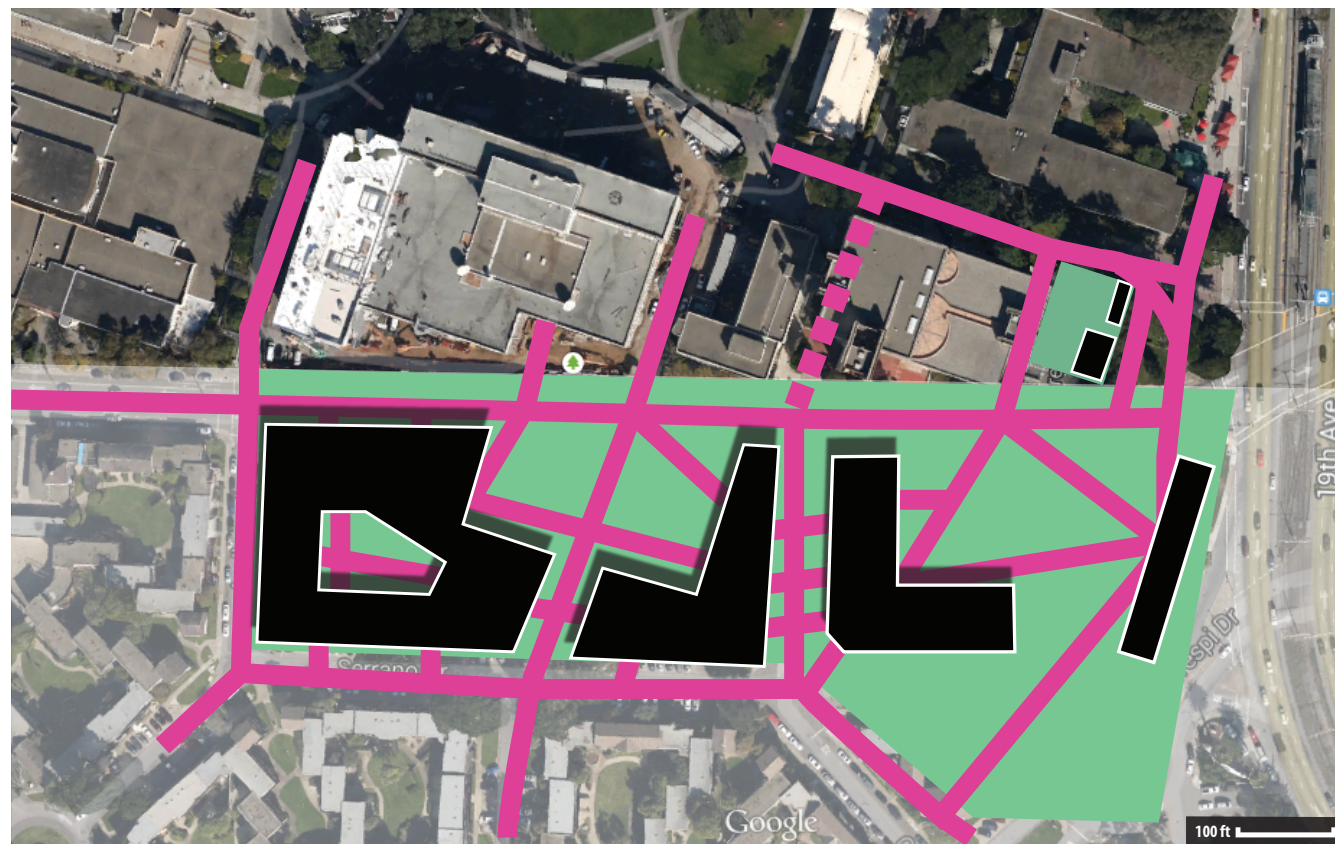



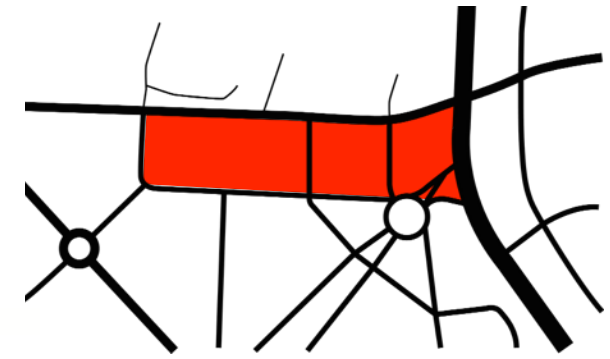



# Cross Sections

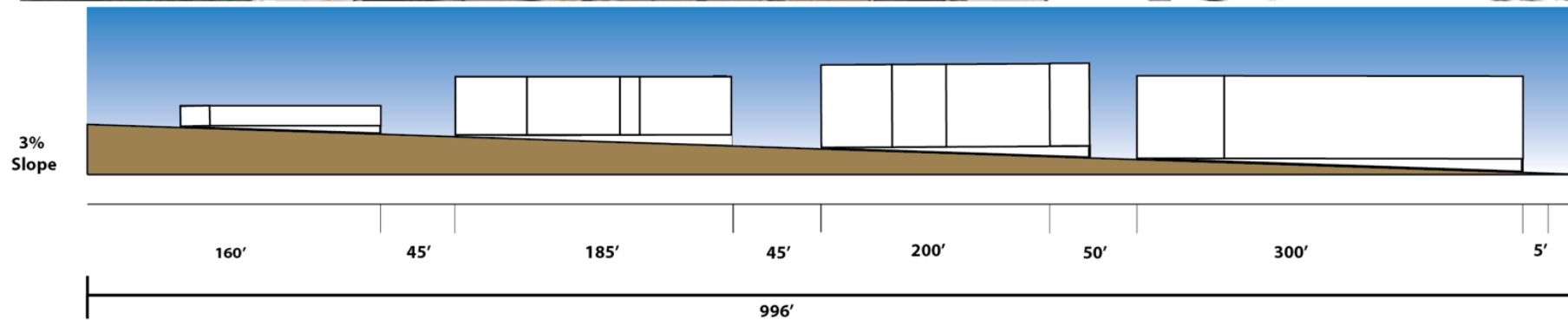
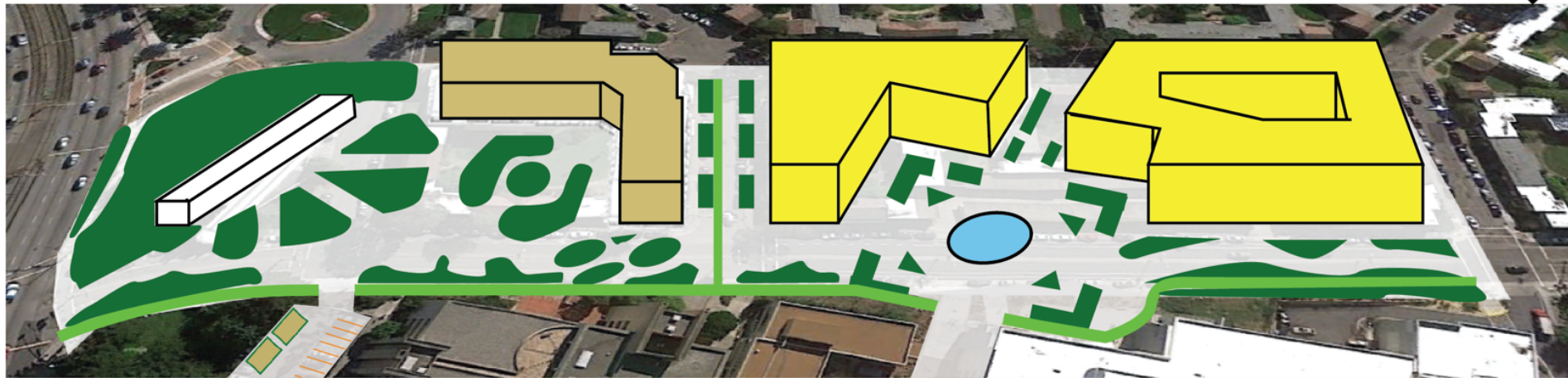
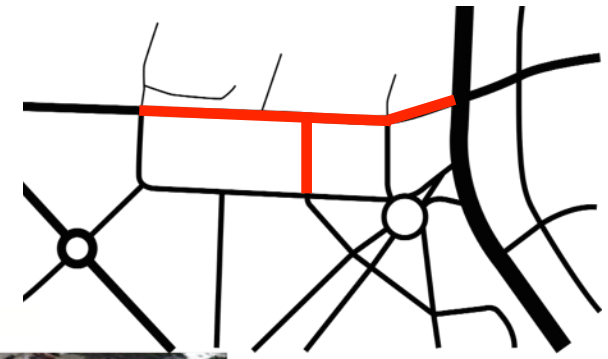

Cardenas Avenue

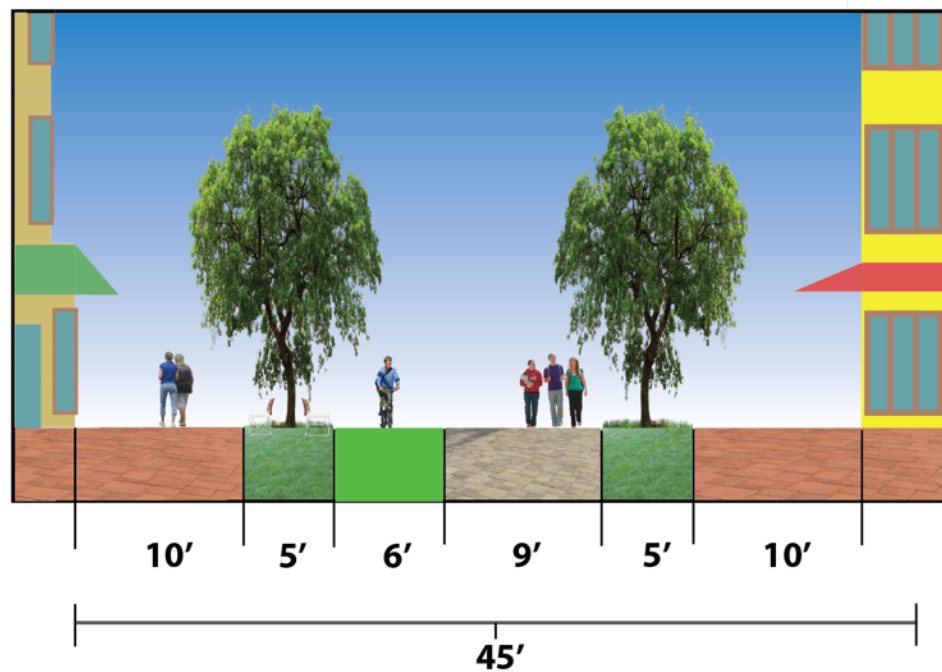

Holloway Avenue

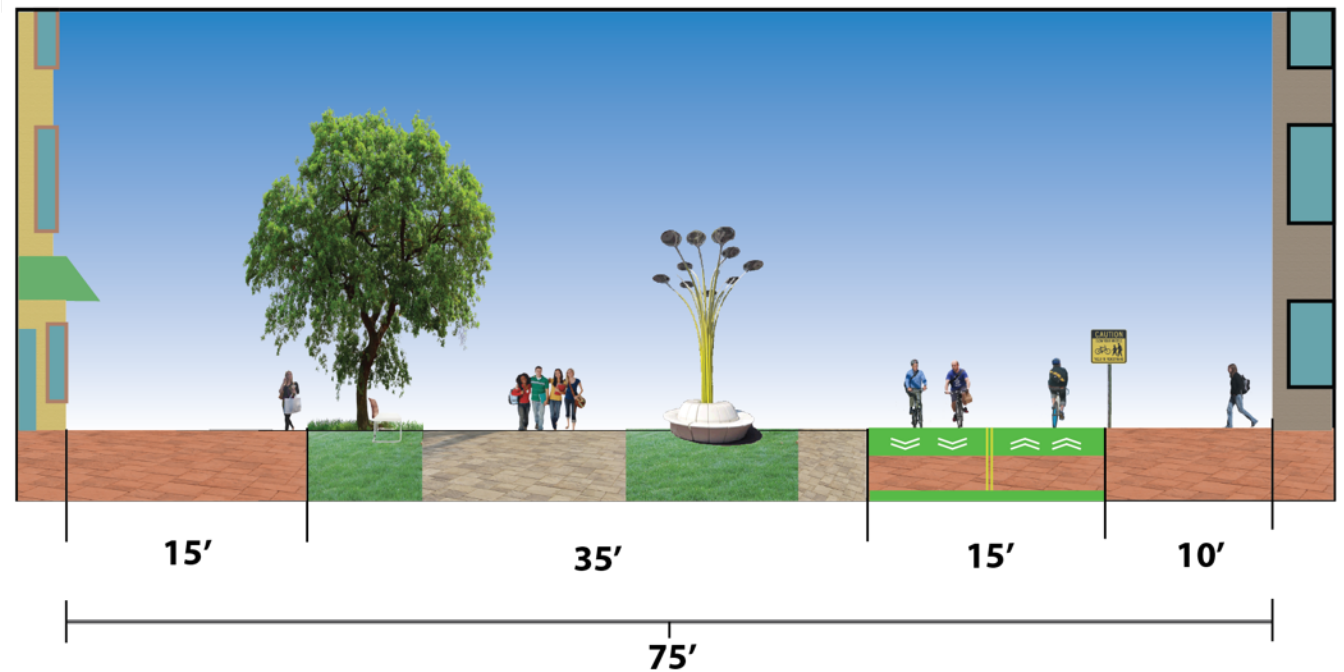



# Bike Parking

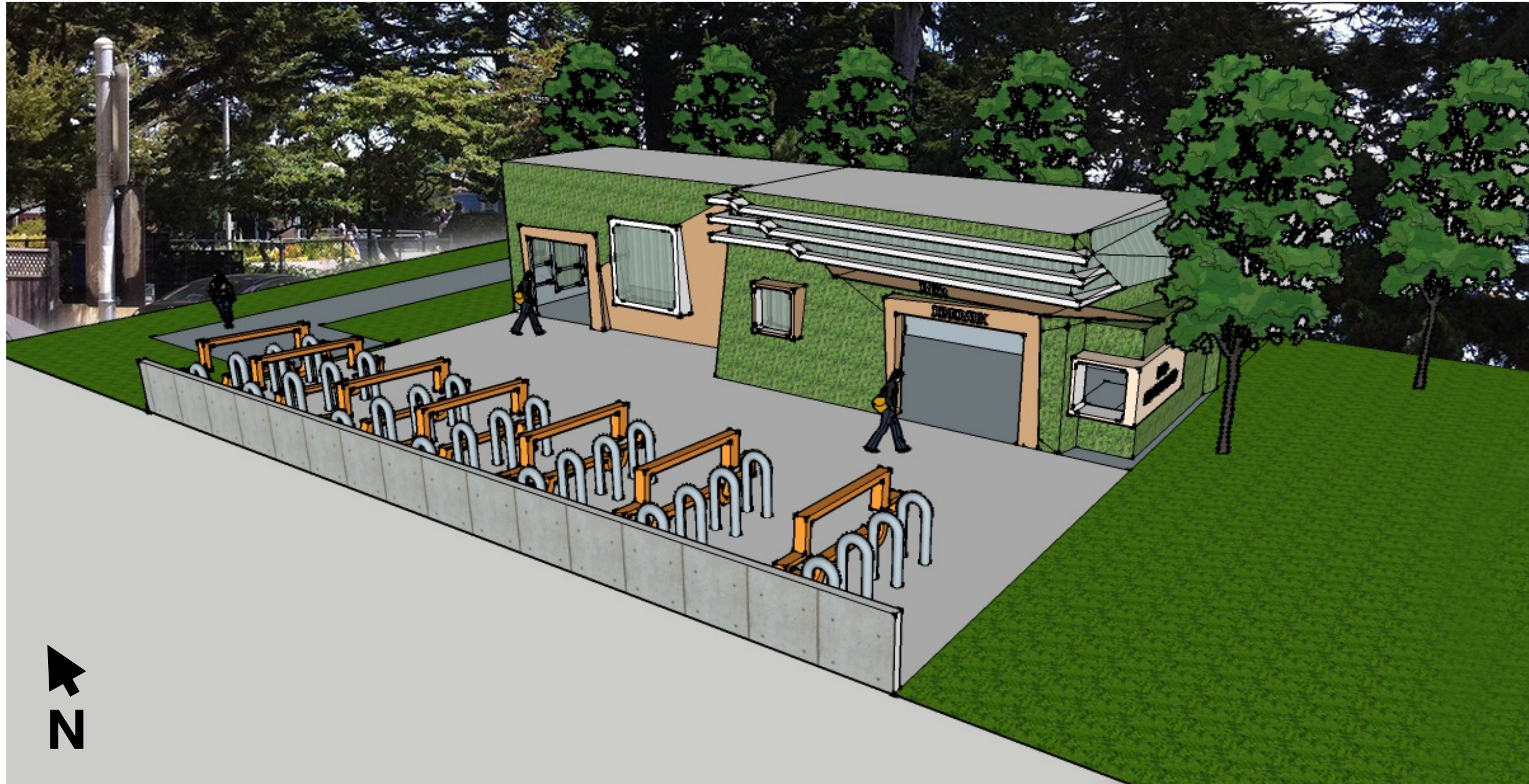
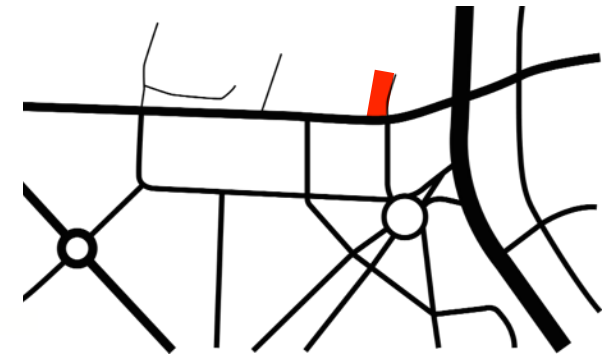



# Entrance

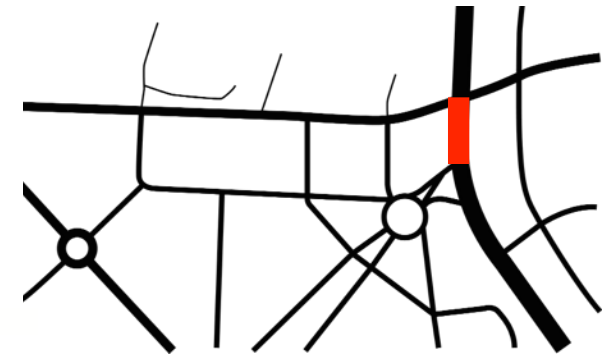



# Sustainability

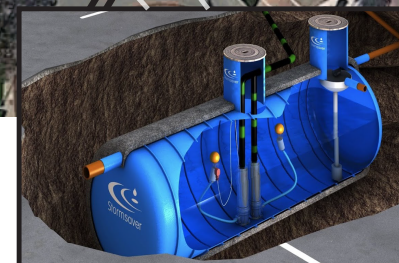
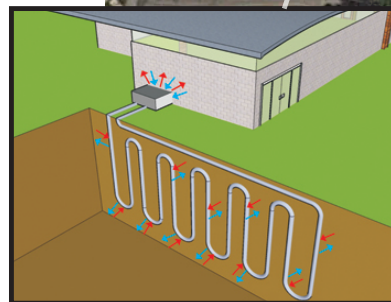
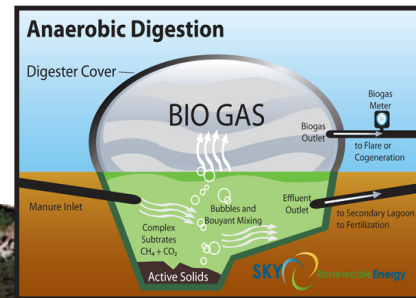
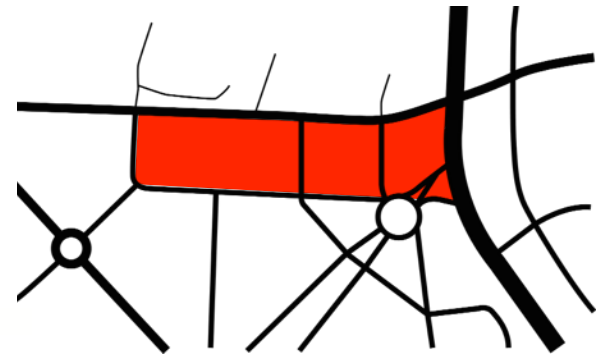



# Building Specs

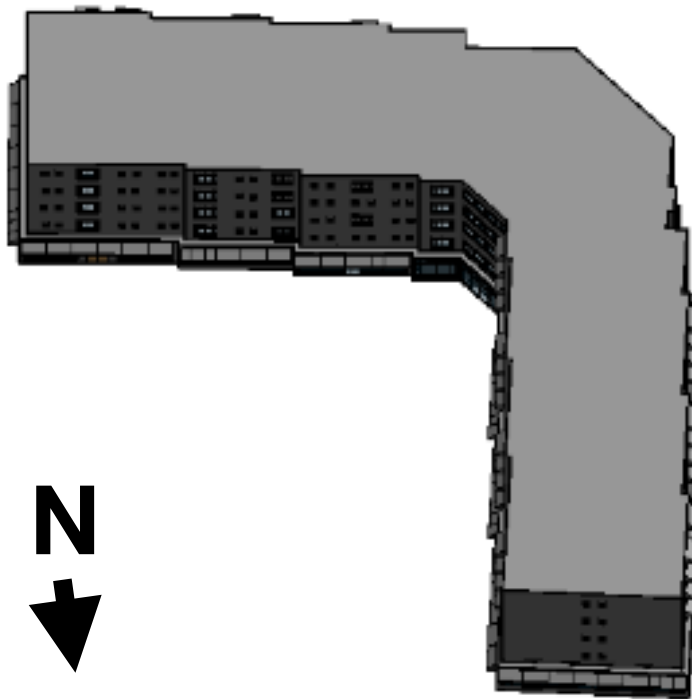
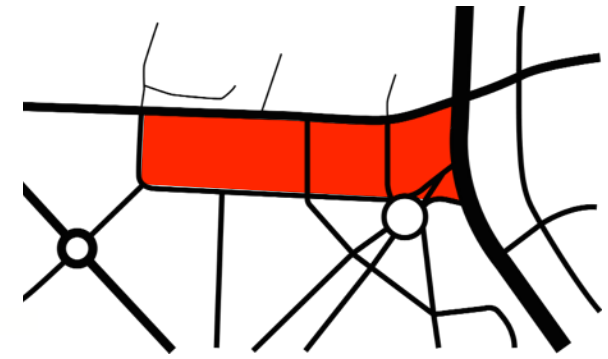

- 5 stories, 60' height
- 21,000 ft<sup>2</sup> per floor
- 67 residential units
- 206 students

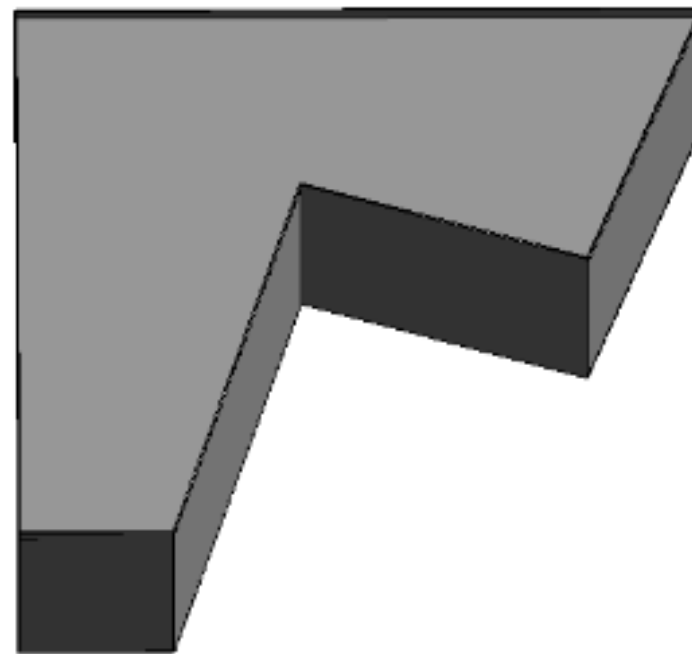

- 6 stories, 70' height
- 25,000 ft<sup>2</sup> per floor
- 350 dwelling units
- 700 students

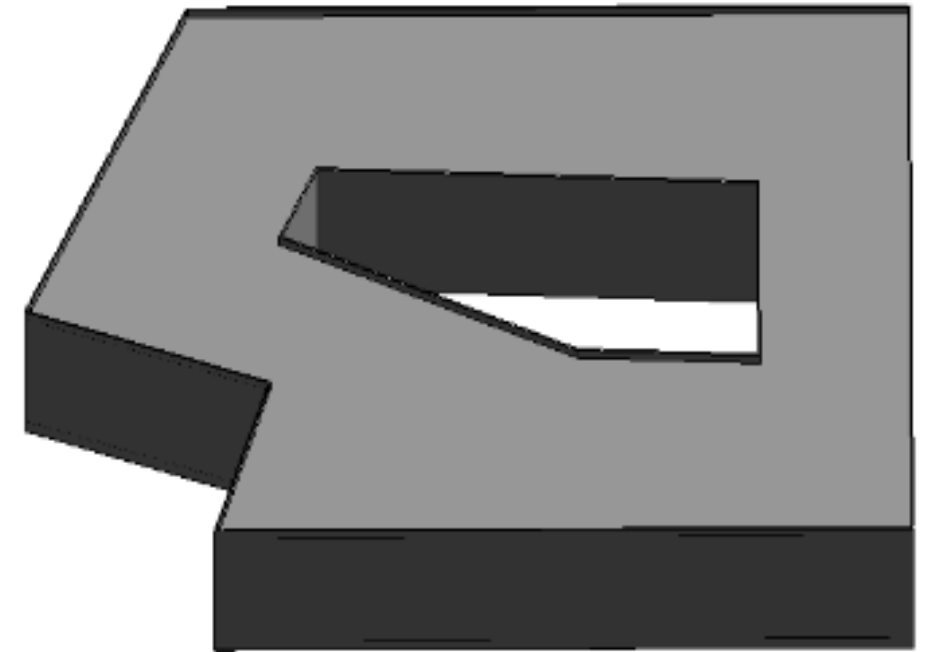

- 6 stories, 70' height
- 40,000 ft<sup>2</sup> per floor
- 600 dwelling units
- 1,200 students



# Thank You

